

# Commander 2

Shared charging made easy



wallbox 

## COMMANDER 2

# Smart EV charging at your fingertips

**Wallbox Commander 2** was designed to make your charger more interactive by placing all the controls at your fingertips. Combined with the myWallbox platform, it offers a full range of functions to control your charger status, users, energy consumption and much more.



### **Powerful EV charge**

Up to 22 kW of charging capacity.



### **Compatible**

Commander 2 is available with type 1 and type 2 charging cables.



### **Durability**

Safely install and use your charger indoors or outdoors.



### **Three year warranty**

Developed and manufactured in Europe, Commander 2 is designed to last.

## COMMANDER 2

# Intelligent and convenient EV charging



### Easy to use

The built-in touchscreen makes it easy to unlock and choose charge settings.



### Easy to share

Secure shared access with password protection, RFID cards, or the myWallbox app.



### Connected

Connects to any smart device via Wi-Fi, Bluetooth, Ethernet, or 4G (optional).



### Controllable

Use the myWallbox platform to control multiple chargers and users, access our energy management solutions, benefit from our integrated payment system, and more.



### Power Sharing

Connect two or more chargers to the same electrical circuit. Commander 2 integrated software intelligence automatically balances the power distribution across all connected chargers based on each vehicle's need for power, providing optimal charge to all EVs at the same time.



## MYWALLBOX

# Commander 2 is powered by the myWallbox platform

The myWallbox platform offers a range of functions to support your business. Choose the subscription plan that best suits your needs and unlock advanced features such as:

- Multiple users management
- Multiple chargers management
- Dynamic Power Sharing
- An integrated payment system
- Real-time status and statistics

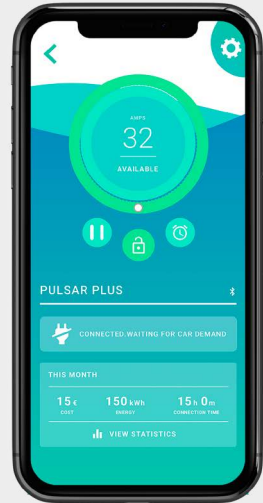

## DYNAMIC POWER SHARING

# Improve your charger intelligence with dynamic load management

Improve your charger intelligence with our dynamic load management solution to avoid blackouts and surprise energy bills. It will measure your building's live energy usage and automatically adjusts the charge to all connected EVs in harmony with your local grid's capacity.

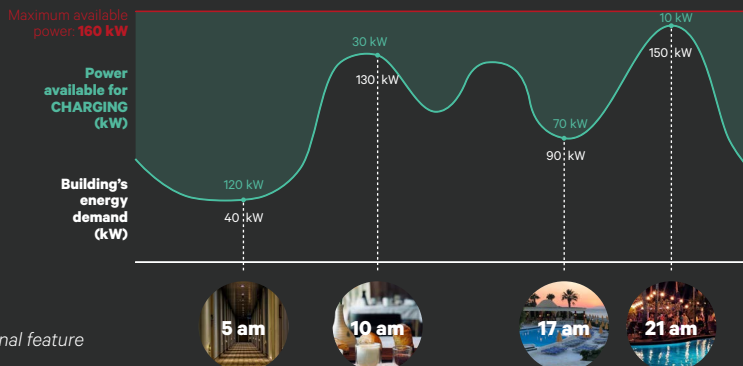

\*Optional feature

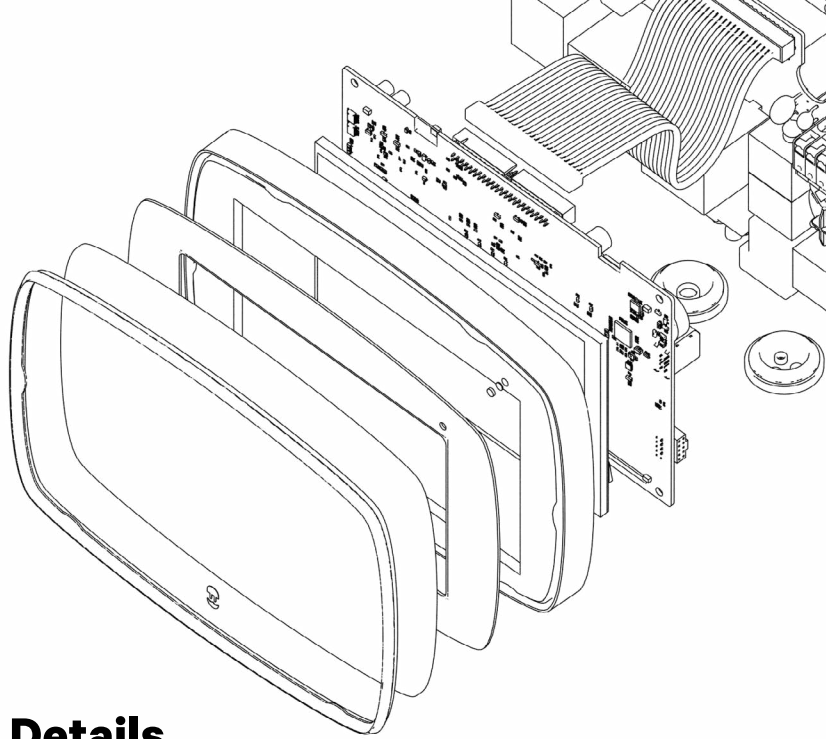

## Product Details

### GENERAL SPECIFICATIONS

<b>Colour:</b>	White or Black
<b>Charging mode:</b>	Mode: 3
<b>Dimensions:</b>	221x152x115 mm (without cable)
<b>Weight:</b>	2,4kg (without cable)
<b>Cable length:</b>	5 m (7m optional)

### CONNECTIVITY & USER INTERFACE

<b>Connectivity:</b>	Wi-Fi / Ethernet / Bluetooth / Optional: 3G-4G
<b>User Identification:</b>	PIN Code / RFID Card / myWallbox app
<b>User Interface:</b>	Touchscreen / myWallbox app & portal
<b>Charger Status:</b>	Touchscreen / RGB LED / myWallbox app & portal
<b>Included Features:</b>	Power Sharing
<b>Optional Features:</b>	Power Boost/Dynamic Power Sharing / MID Meter
<b>Communication Protocol:</b>	myWallbox / OCPP 1.6j

### ELECTRICAL SPECIFICATIONS

<b>Maximum</b>	7,4 kW (1Phase) /
<b>Charging Power:</b>	22 kW (3Phase)
<b>Rated Voltage</b>	220 V to 240 V (7,4kW)
<b>AC±10%:</b>	400 V (11kW and 22kW)
<b>Rated Current:</b>	32 A (7,4 kW - 1Phase) / 16 A (11 kW - 3Phase) / 32 A (22 kW - 3Phase)
<b>Connector type:</b>	Type 1 or Type 2
<b>Cable Section:</b>	5x10mm <sup>2</sup>
<b>Configurable Current:</b>	from 6 A to rated current
<b>Protection Rating:</b>	IP54 / IK10
<b>Residual Current Detection:</b>	DC 6 mA